

INSTRUCTIONS

DG

Rev. 062009 v3



Double Gourd

PARTS LIST

One Double Gourd
One Gourd Entrance
One Porch

Six White Snaps
One Inspection Cap

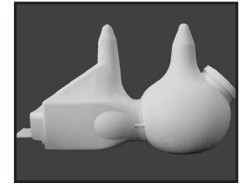

**IF ANY ITEM IS DISCOVERED MISSING,
CALL 1-800-764-8688 · DO NOT RETURN TO STORE.**

READ INSTRUCTIONS COMPLETELY BEFORE STARTING TO ASSEMBLE PORCH UNIT.

Note: The Double Gourd has a startling resistant entrance. The ROUND entrance (sold separately) can be used for first attracting Purple Martins for the first time. The crescent (Starling Resistant Entrance Hole (SREH)) helps protect the Purple Martin family and eggs. Both openings are available from S&K Manufacturing, Inc.

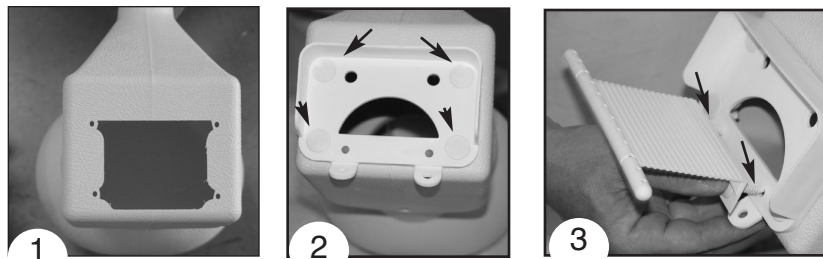

1. The large cutout on the Double Gourd is the location for the entrance and porch assembly. Follow instructions carefully. Once the white snaps are pushed into place, they are made NOT to be removed.

2. Align the four snap holes at the corners of porch entrances (see arrows in image #2) and insert the four snaps.

3. Line up the porch as shown in image #3 and insert the two snaps through the porch hole and the Gourd Entrance.

**S&K GOURDS ARE PERFECT FOR HANGING
BELOW AN S&K MARTIN HOUSE OR USE
THEM WITH AN S&K DOUBLE GOURD
HANGER AND AN S&K TRI-TEL POLE!**

INFORMATION ABOUT ENTRANCES...

Purple Martins have a natural enemy - the Starling. Starlings invade the nests of Purple Martins and destroy eggs. They do not eat the eggs, but are just destructive by nature. The crescent-shaped SREH entrance thwarts Starlings - it's the perfect size for Martins, but is too small for the destructive Starlings.

If you have trouble getting martins to nest in your Double Gourd, contact S&K for a Round Hole entrance for your Double Gourd. After the Martins have nested, you can easily replace the round opening with an SREH opening. Your new S&K Double Gourd offers the best of both worlds - you can order either a round entrance or use the supplied SREH (Crescent) Opening.

CLEANING!

There may be times when you'll need to clean out your Double Gourd. Simply remove the Inspection Cap on the unit and reach inside to remove unwanted debris. Replace the cap securely after cleaning.

For more S&K Purple Martin products, be sure to visit our website at:

www.skmfg.com • 1-800-764-8688

1001 Liberty Industrial Drive • O'Fallon, Mo 63366