

INSTRUCTIONS

BVG

Hanging S&K Bo Villa Martin House/Gourd



Please read all directions before starting assembly.

IF ANY ITEMS ARE DISCOVERED MISSING, CALL 1-800-764-8688 · DO NOT RETURN TO STORE.

PARTS LIST

- *Bo Villa Gourd Unit*
- *2 Porches*
- *Round Hole Entrance Cap*
- *Qty 2, Snaps*
- *Inspection Cap*

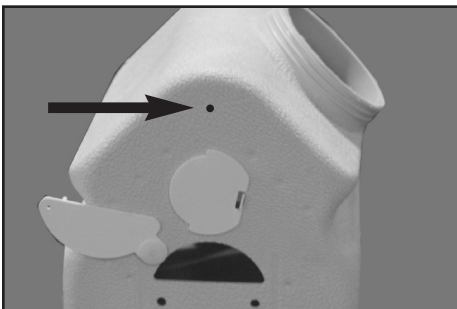

1. Drill a hole for hanging your Bo Villa at the top front of the Bo Villa. Drill a second hole in same location into the back of the Bo Villa - so the hanging rod can be pushed through the length of the Bo Villa. Determine the size of the holes based on what will be used to hold the Bo Villa.

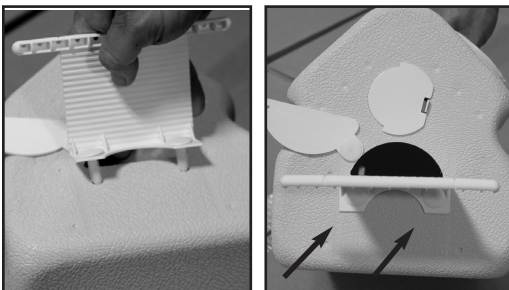

2. Attach porch to outside of Bo Villa Gourd with snaps. Push snaps securely through the two openings as shown on left.

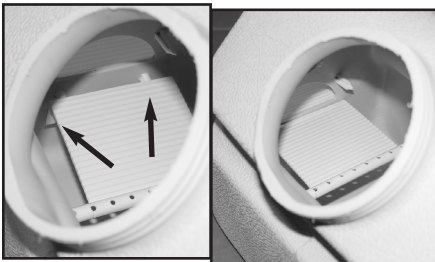

3. Remove Inspection/Clean-out Port Cap in place. Insert second porch through the inspection/clean-out port. Align porch with snaps protruding from outside porch. Push the two snap openings on the inside porch fully onto snaps, as shown above. Replace Inspection/Clean-out Port Cap.

Helpful Hints From S&K



To Attract Purple Martins, initially leave the top round hole open, with the Starling Resistant Entrance Hole (SREH) closed.

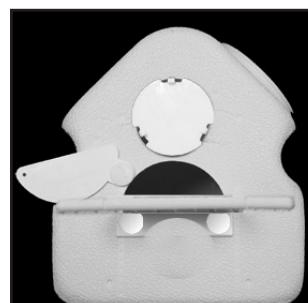

After Purple Martins have established their new home, use the Round Hole Entrance Cap to plug the round entrance and open the SREH as shown. This will help protect the nest from Starlings.

S&K Manufacturing, Inc. • 1001 Liberty Industrial Drive • O'Fallon, Mo 63366
www.skmg.com • 1-800-764-8688